

EBE

FRAME SERIES

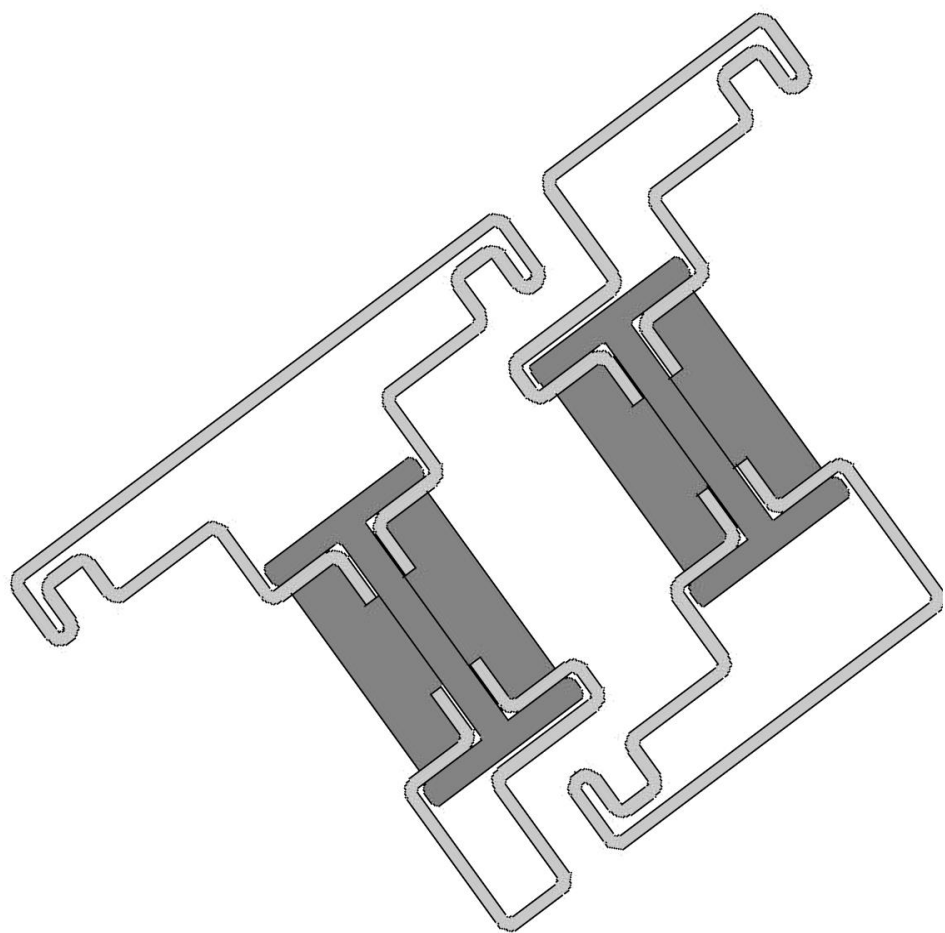

DIRECT FIXED

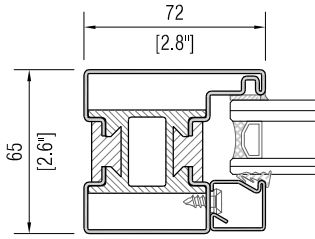

P.1001

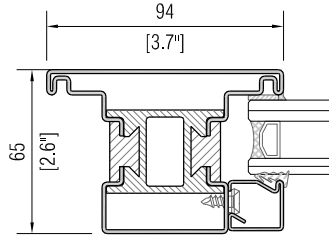

P.1002

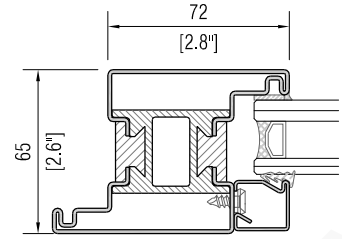

P.1003

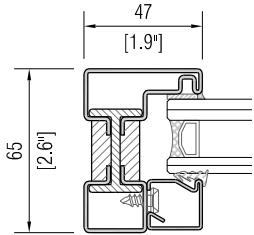

P.1201

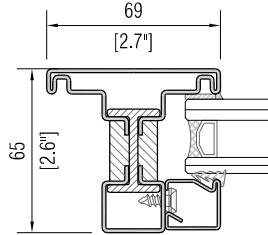

P.1202

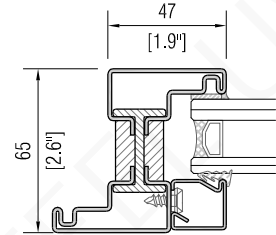

P.1203

INSWING WINDOW

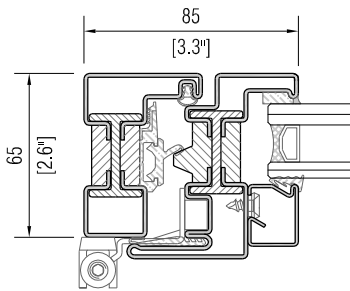

P.1201 - P.1233

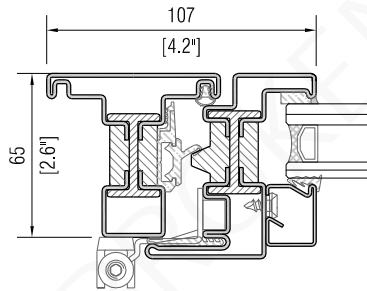

P.1202 - P.1233

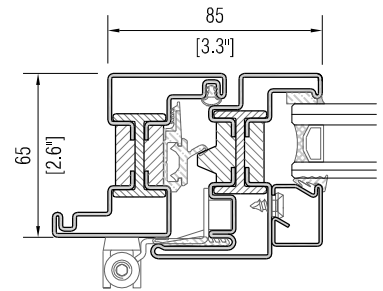

P.1203 - P.1233

INSWING DOOR

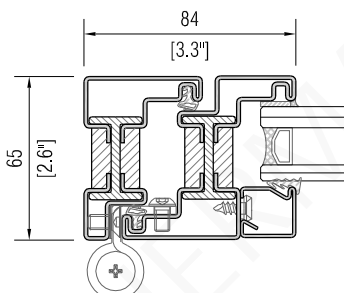

P.1211 - P.1213

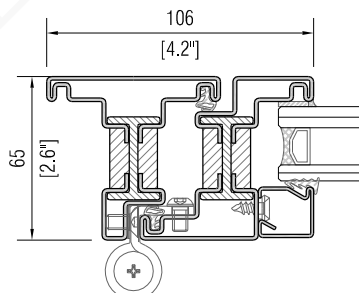

P.1212 - P.1213

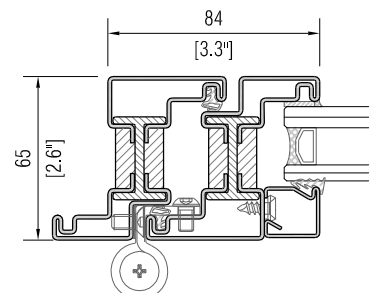

P.1213 - P.1213

OUTSWING WINDOW AND DOOR

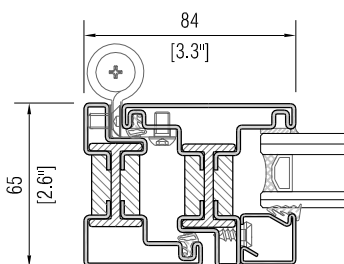

P.1211 - P.1212

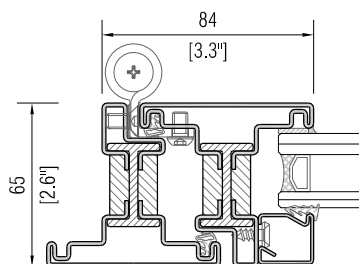

P.1212 - P.1212

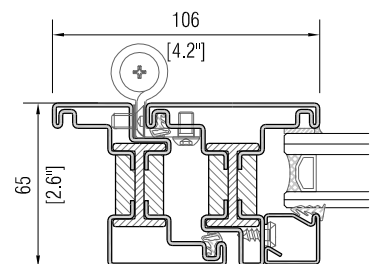

P.1213 - P.1212

SILL DETAILS | Inswing

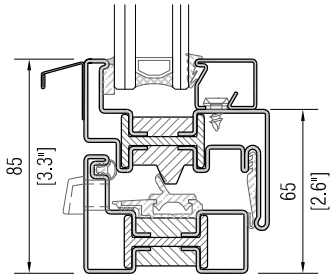

P.1201 - P.1233 | Window

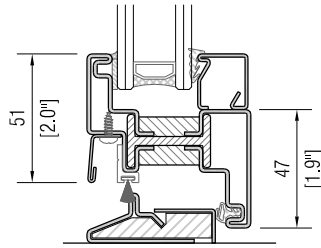

P.1213 | Door

SILL DETAILS | Outswing

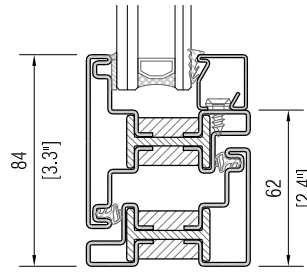

P.1211 - P.1212 | Window

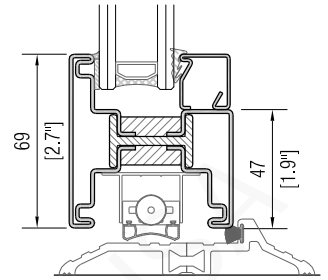

P.1205 | Door

OPERABLE NEXT TO FIXED | Inswing Window

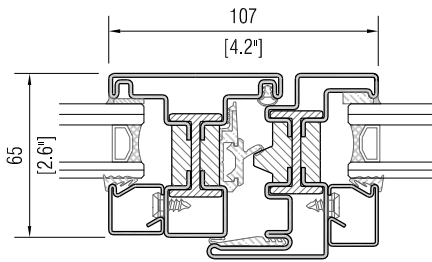

P.1202 - P.1233

OPERABLE NEXT TO FIXED | Outswing Window

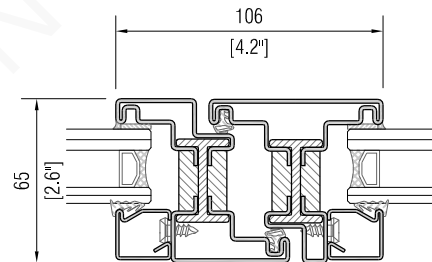

P.1213 - P.1212

OPERABLE NEXT TO FIXED | Inswing Door

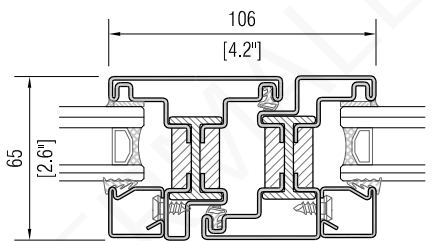

P.1213 - P.1213

OPERABLE NEXT TO FIXED | Outswing Door

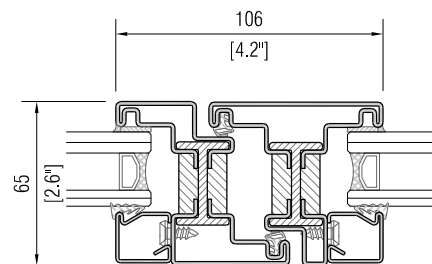

P.1213 - P.1212

GLAZING BEADS

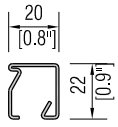

P.1007 | Regular

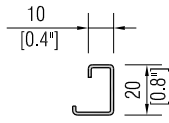

P.2015 | Regular

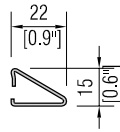

P.2629 | Sloped

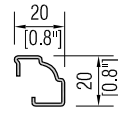

P.2028 | Gothic

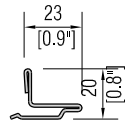

P.2038 | Thin

SDL | Simulated Divided Lites

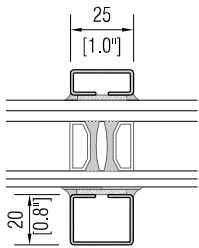

REGULAR 20

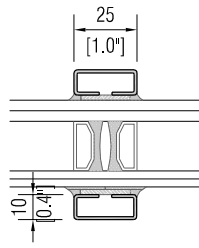

REGULAR 10

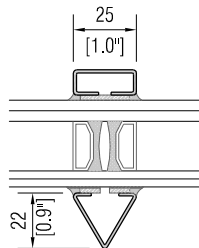

SLOPED

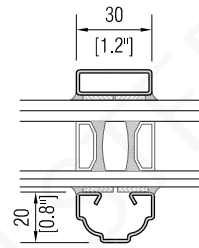

GOTHIC

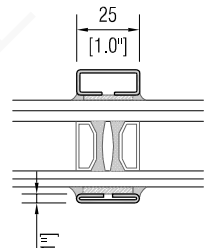

THIN

TDL | True Divided Lites

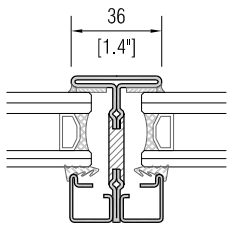

P.2664

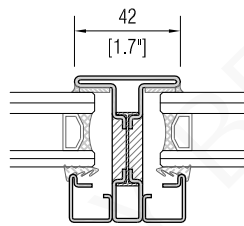

P.2872

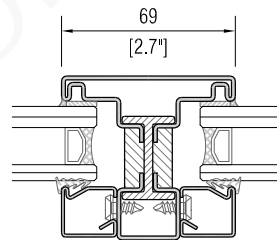

P.1222

It's not just a window or door, it's history

VISIONARY INNOVATORS
CAPTURING THE WORLD'S MOST
luxurious portrait.