

# OS2

FRAME SERIES

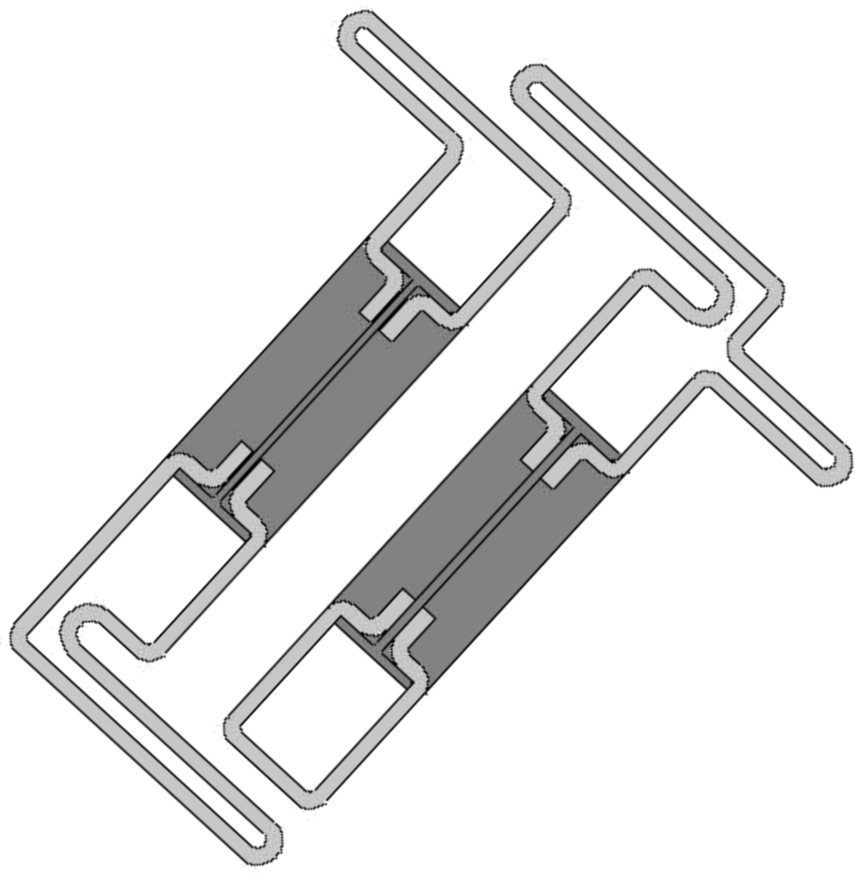

**DIRECT FIXED**

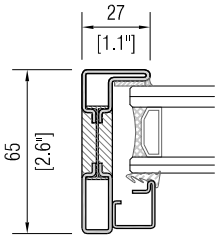

P.2851

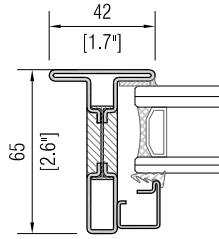

P.2852

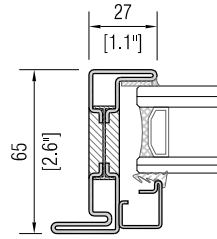

P.2853

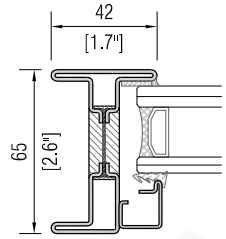

P.2855

**FIXED WINDOW**

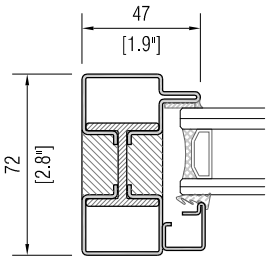

P.2891

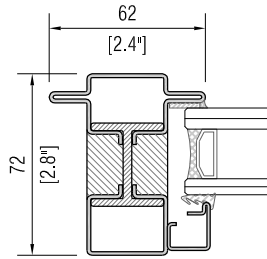

P.2892

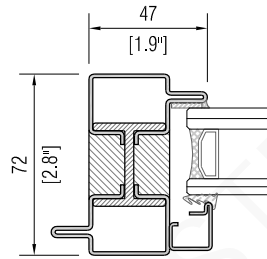

P.2893

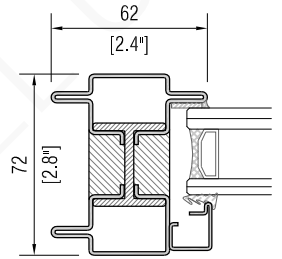

P.2895

**INSWING WINDOW AND DOOR**

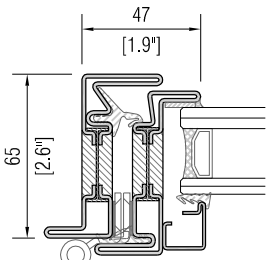

P.2803 - P.2833

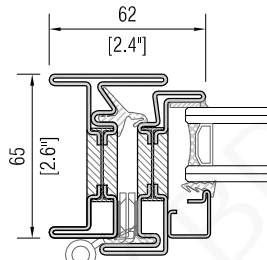

P.2805 - P.2833

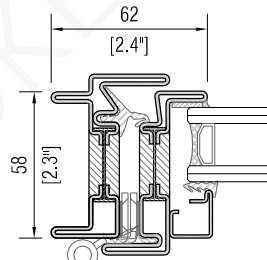

P.2815 - P.2833

**OUTSWING WINDOW AND DOOR**

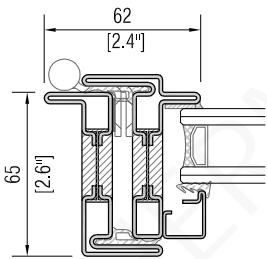

P.2863 - P.2862

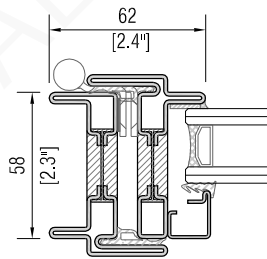

P.2865 - P.2862

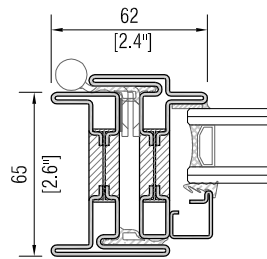

P.2885 - P.2862

**SILL DETAILS | Inswing**

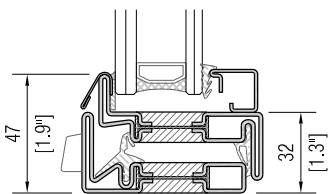

P.2801 - P.2833 | Window

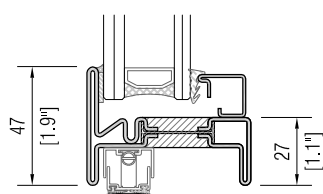

P.2805 | Door

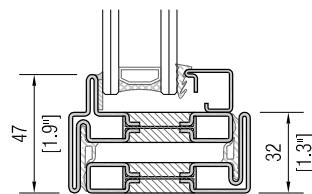

P.2861 - P.2862 | Window

**SILL DETAILS | Outswing**

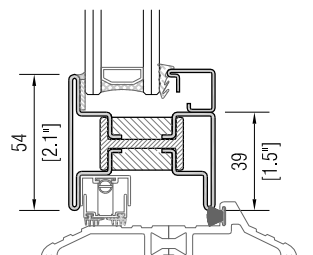

P.2655 | Door

OPERABLE NEXT TO FIXED | Inswing

OPERABLE NEXT TO FIXED | Outswing

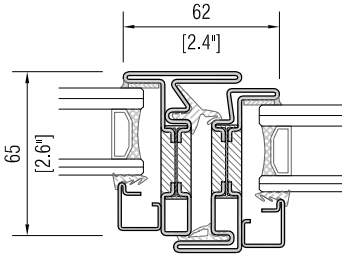

P.2822 - P.2833

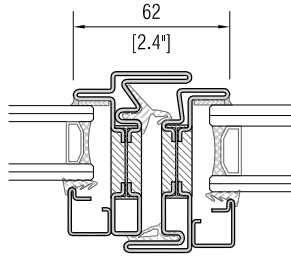

P.2842 - P.2833

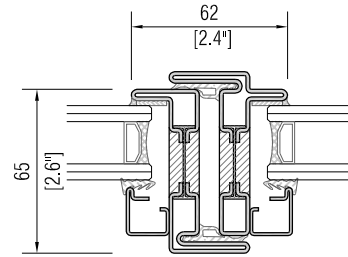

P.2863 - P.2862

GLAZING BEADS

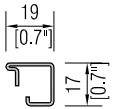

P.2607 | Regular

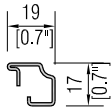

P.2627 | Grooved

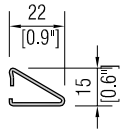

P.2629 | Sloped

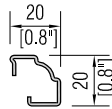

P.2028 | Gothic

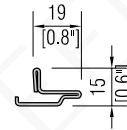

P.2638 | Thin

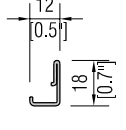

HTS 6010 | J

SDL | Simulated Divided Lites

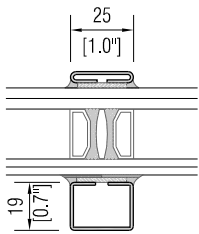

REGULAR 19

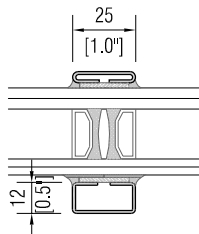

REGULAR 12

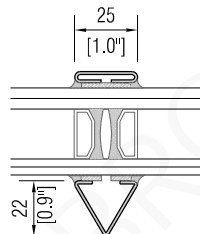

SLOPED

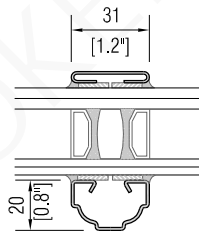

GOTHIC

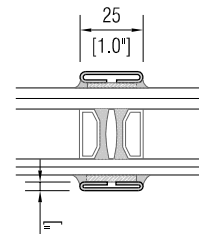

THIN

TDL | True Divided Lites

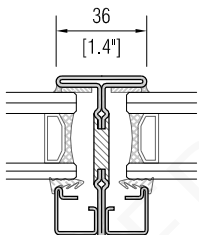

P.2654

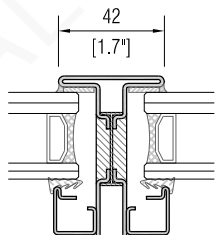

P.2852

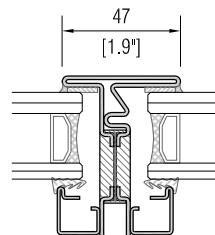

P.2822

*It's not just a window or door, its history*

VISIONARY INNOVATORS  
CAPTURING THE WORLD'S MOST  
*luxurious portrait.*